

KEMET, FLLE2-PV, EMI/RFI Filters, Noise Suppression, 1.2 kV, 400 A, 300x130x100mm

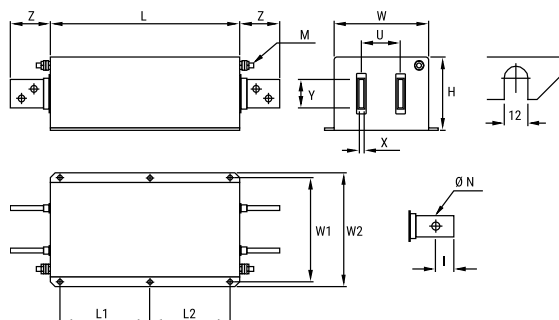

Dimensions	
L	300mm NOM
W	130mm NOM
H	100mm NOM
L1	130mm NOM
L2	110mm NOM
W1	165mm NOM
W2	180mm NOM
U	70mm NOM
X	6mm NOM
Y	25mm NOM
Z	58mm NOM
I	15mm NOM
N	10.5mm NOM
M (Earth)	Threaded Studs M10
Lead	Threaded Studs M10

Packaging Specifications	
Packaging:	Bulk
Packaging Quantity:	1
Weight:	7 kg

General Information	
Series:	FLLE2-PV
Style:	Chassis Mount
Description:	EMI Filter, With Y Capacitor
Features:	Single Phase, Photovoltaic Applications
RoHS:	Yes
Qualifications:	IEC/EN 60939, UL 1283
Lead:	Threaded Studs M10

Specifications	
Voltage DC:	1200 VDC
Ripple Current:	400 A (50°C)
Rated Temperature:	55°C
Temperature Range:	-40/+100°C
Climate Category:	40/100/21
Test Voltage DC (P to P):	3000 VDC
Test Voltage DC (P to E):	3600 VDC
Voltage:	1200 VDC, 3000 VDC (Test P to P), 3600 VDC (Test P to E)
Power Loss:	15 W (25°C 50 Hz)