

Aug.1.2025 Copyright 2025 HIROSE ELECTRIC CO., LTD. All Rights Reserved.
In case of consideration for using Automotive equipment / device which demand high reliability, kindly contact our sales window correspondents.

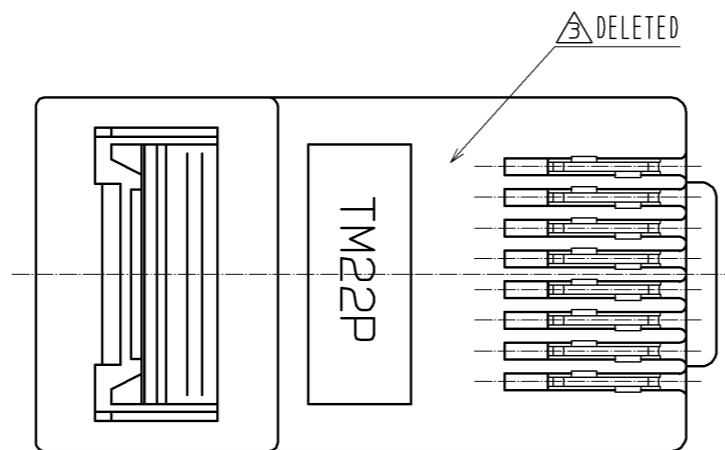
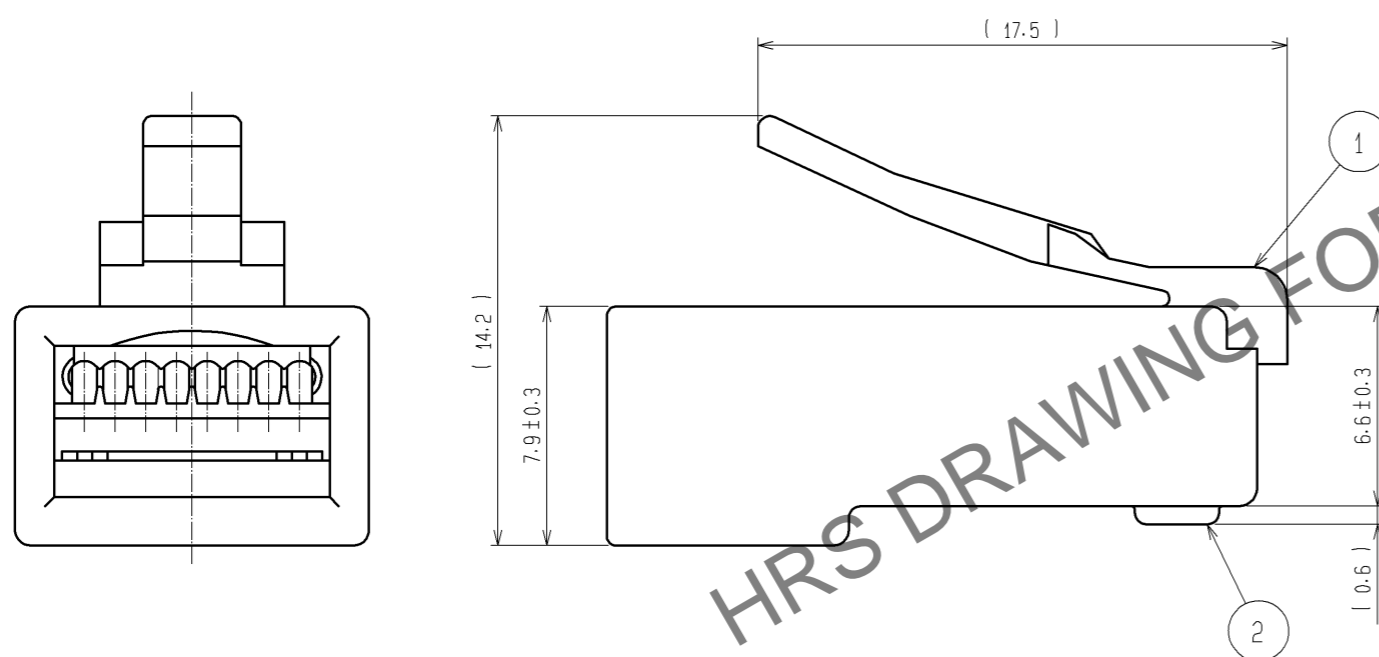
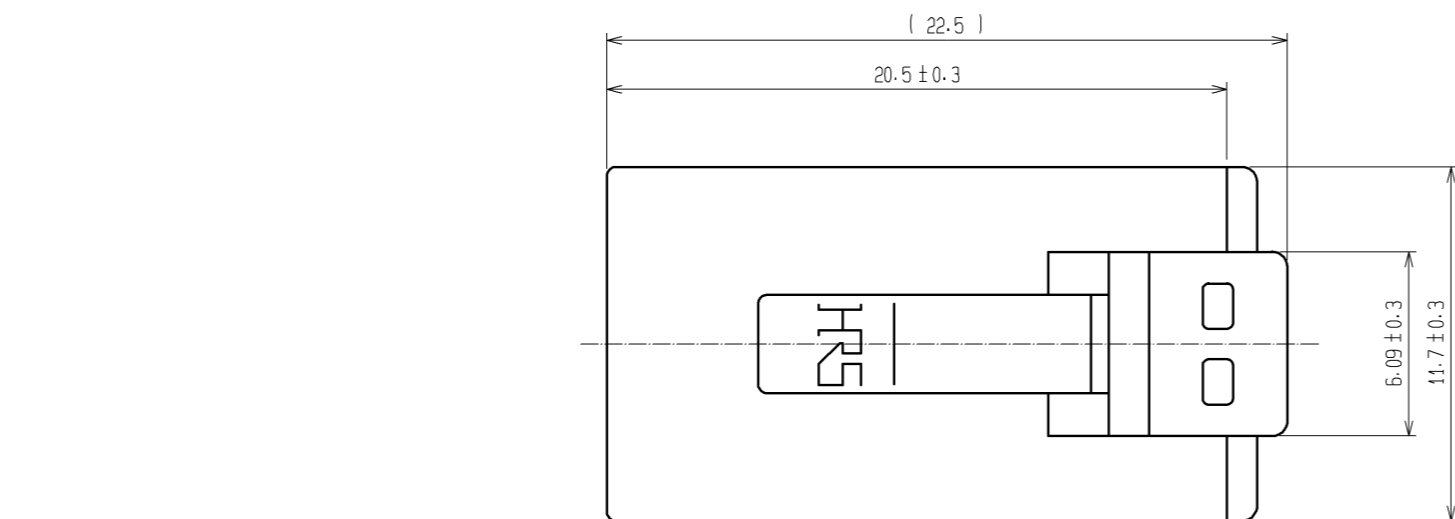
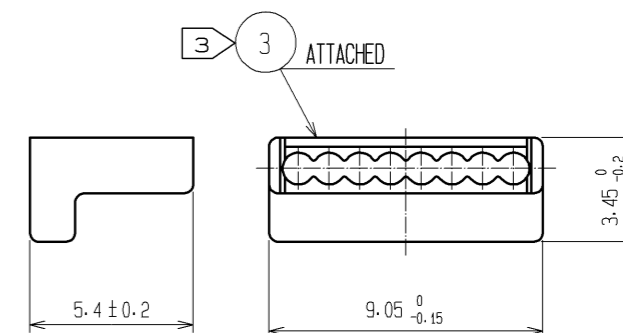
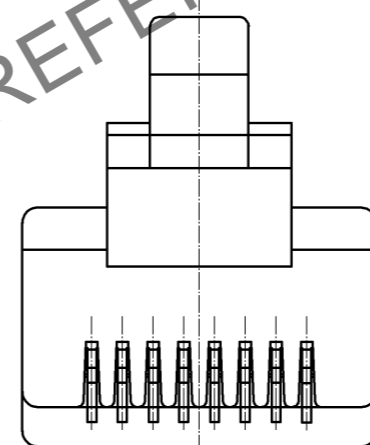

TABLE-1

APPLICABLE CABLE WIRE		
	CONDUCTOR	$\phi 0.5\text{mm}$ SOLID WIRE AWG#24 STRANDED WIRE (7/ $\phi 0.2\text{mm}$)
	INSULATOR DIAMETER	($\phi 0.9 \sim \phi 1.0$)
JAKET DIAMETER		($\phi 5.4 \sim \phi 5.7$)



- NOTES
- () INDICATES THE REFERENCE DIMENSIONS.
 - APPLICABLE CABLE IS SHOWN IN TABLE-1.
 - PLEASE USE ACCESSORY AS A GUIDE PLATE AND ASSEMBLE CONNECTOR WITH CABLES INSERTING ACCESSORY INTO CONNECTOR.
 - TO SATISFY CAT5e PERFORMANCE, PLEASE ASSEMBLE ACCORDING TO HRS INSTRUCTION.
 - FOR THE CABLE ASSEMBLY, USE THE SPECIFIED HAND TOOL (HT601-TM23/22P-88P) OR THE APPLICATOR (AP105-TM22P-88P).

1	POLYCARBONATE	(CLEAR) UL94V-2	3	POLYCARBONATE	(CLEAR) UL94V-2
			2	PHOSPHOR BRONZE	CONTACT: Au 1.27 μm min OTHER: Au 0.03 μm min UNDER: Ni 2 μm min
NO.	MATERIAL	FINISH . REMARKS	NO.	MATERIAL	FINISH . REMARKS
UNITS mm		SCALE 2 : 1	COUNT 1	DESCRIPTION OF REVISIONS DIS-E-002126	DESIGNED MT. ITANO
HIROSE ELECTRIC CO., LTD.		APPROVED : HO. MIWA	05.01.05	DESIGNED MT. ITANO	CHECKED HK. TANAKA
		CHECED : TH. KAMEYA	05.01.05	DATE 08.02.12	
		DESIGNED : SS. SATOH	05.01.05	DRAWING NO. EDC3-122975-00	
		DRAWN : SS. SATOH	05.01.05	PART NO. TM22P-88P	
				CODE NO. CL222-2899-9-00	
				1/1	